



Juncor 



ZON™

BEARINGS FOR YOUR FUTURE

**CATÁLOGO DE
ROLAMENTOS PARA
BICICLETAS**





ZON™

BEARINGS FOR YOUR FUTURE

Cycle Bearings Catalogue



TÜVRheinland®
CERT
Certified ISO 2008
Management System
according to ISO 9001:2008





BEARINGS FOR YOUR FUTURE

Zen Ball Bearings are manufactured to the highest quality for standard and non-standard applications. Our technical department can modify any non-standard bearings to your specific requirements, regardless of quantity.

Apart from our extensive miniature ball bearing range of more than 1000 different types, ranging from 1-10 mm bore (Including inch dimensions), our range also includes Thin section, Three part thrust, Popular metric and any kind of non standard bearing. We are able to design bearings according to your requirements using new materials like ceramic or special steels for applications in Industry, Medicine, Chemistry and Food Processing.

Our technical department can modify any non-standard bearings to your specific requirements, even for small quantities.

For any items not listed in our catalogue, please contact our experienced sales team.



Zen Ball Bearings Shanghai has been awarded the German ISO TUV Rheinland certification for inspection of ZEN products.

This certification is the highest standard a business in our industry can achieve. It is internationally recognised as a guarantee of quality, customer focus and continual improvement.

www.zen.biz



Fahrradlager Cycle Bearings



Wetterbeständig
Outdoor durability



Ölschmierung
Oil lubrication



Keine Schmierung
No lubricant



Fettschmierung
Grease lubrication



Geeignet für niedrige temperaturen
Suitable for low temperatures



Geeignet für hohe temperaturen
Suitable for high temperatures



Lösungsmittelresistent
Chemical solvent resistant



Geeignet für hohe drehzahlen
Suitable for high speed applications



Gummidichtscheiben verfügbar
Rubber seal option available



Metalldeckscheiben verfügbar
Metal shield option available

ACB Steuersatz Lager / ACB Headset Bearings

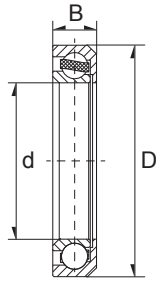

3

Ref Type	Dimension (mm)			Inner ring angle	Outer ring angle	Weight Kg
	ID	OD	W			
ACB-3645-30-A-RS	30	41	6.5	36°	45°	0.021
ACB-4545-30-A-RS	30	41	6.5	45°	45°	0.02
ACB-4545-30-B-RS	30	41.8	7	45°	45°	0.024
ACB-4545-30-C-RS	30	41.8	8	45°	45°	0.024
ACB-4545-30-F-C-RS	30.5	41.8	8	45°	45°	0.023
ACB-4545-34-B-RS	34	47	7	45°	45°	0.028
ACB-3645-40-A-RS	40	52	6.5	36°	45°	0.033
ACB-3645-40-B-RS	40	52	7	36°	45°	0.033
ACB-3645-40-C-RS	40	51.8	8	36°	45°	0.033
ACB-4545-40-B-RS	40	52	7	45°	45°	0.031
ACB-4545-40-C-RS	40	52	8	45°	45°	0.034

K Steuersatz Lager / K Headset Bearings

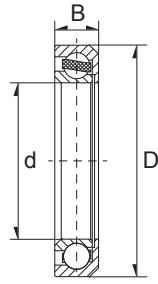

4

Ref Type	Dimension (mm)			Inner ring angle	Outer ring angle	Weight Kg
	d	D	B			
K945H6.3	27.15	38.00	6.3	45°	45°	?
K936H6.5	27.15	38.00	6.5	36°	45°	?
K3039H6.5	30.15	39.00	6.5	45°	45°	?
K345H6.5	30.15	41.00	6.5	45°	45°	?
K345H7	30.15	41.00	7.0	45°	45°	
K345H7.7	30.15	41.00	7.7	36°	45°	
K336H6.5	30.15	41.00	6.5	36°	45°	
K336KH6.5	30.15	41.00	6.5	36°	36°	
K845H6.5	30.15	41.80	6.5	45°	45°	
K845H7	30.20	41.80	7.0	45°	45°	
K845H8F	30.50	41.80	8.0	45°	45°	
K845H8	30.50	41.80	8.0	45°	45°	
K845H7.7	30.50	41.80	7.7	45°	45°	
K418H6	32.70	41.80	6.0	45°	45°	
K32483H7	32.40	43.80	7.0	45°	45°	
K3344H5	33.00	44.00	5.0	45°	45°	
K34468H7	34.10	46.80	7.0	45°	45°	
K34469H7	34.10	46.90	7.0	45°	45°	
K3544H5	35.00	44.00	5.0	45°	45°	
K3547H7	35.00	47.00	7.0	45°	45°	
K3547H8	35.00	47.00	8.0	45°	45°	
K37469H6.5	37.00	46.90	6.5	45°	45°	
K3749H6.5	37.00	49.00	6.5	45°	45°	
K3749H7	37.00	49.00	7.0	45°	45°	
K3748H7	37.00	48.00	7.0	45°	45°	
K4051H7	40.00	51.00	7.0	45°	45°	
K515H7	40.00	51.50	7.0	45°	45°	
K518H8	40.00	51.80	8.0	45°	45°	
K518KH8	40.00	51.80	8.0	36°	45°	
K519H8	40.00	51.90	8.0	45°	45°	
K4052H6.5	40.00	52.00	6.5	45°	45°	
K4052KH6.5	40.00	52.00	6.5	36°	45°	
K4052H7	40.00	52.00	7.0	45°	45°	
K4052H8	40.00	52.00	8.0	45°	45°	
K4052H12	40.00	52.00	12.0	45°	45°	

Vollrollige Lager / Full Complement

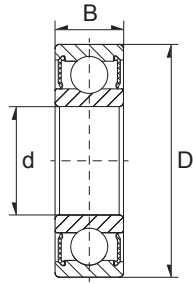

5

Ref Type	Dimension (mm)			Weight Kg
	ID	OD	W	
FB608-2RS	8	22	7	0.012
FB688-2RS	8	16	5	0.004
FB6000-2RS	10	26	8	0.018
FB61800-2RS	10	19	5	0.005
FB61900-2RS	10	22	6	0.01
FB7900-2RS	10	22	6	0.01
FB61901-2RS	12	24	6	0.019
FB7901-2RS	12	24	6	0.01
FB61802-2RS	15	24	5	0.07
FB61902-2RS	15	28	7	0.019
FB7902-2RS	15	28	7	0.019
FB17286-2RS	17	28	6	0.013
FB17287-2RS	17	28	7	0.014
FB61903-2RS	17	30	7	0.019
FB215317-2RS	21.5	31	7	0.01
FB61805-2RS	25	37	7	0.024
FB61808-2RS	40	52	7	0.035
FB61809-2RS	45	58	7	0.042

Freilauf / Hub Bearings

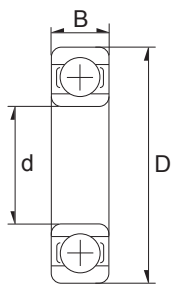

6

Ref Type	Dimension (mm)			Weight Kg
	ID	OD	W	
398-2RS	8.00	19.00	11.00	
3800-2RS	10.00	19.00	8.00	
3801-2RS	12.00	21.00	8.00	
3001-2RS	12.00	28.00	12.00	
3802-2RS	15.00	24.00	8.00	
15267-2RS	15.00	26.00	7.00	
15268-2RS	15.00	26.00	8.00	
152610-2RS	15.00	26.00	10.00	0.011
15267-2RS	15.00	26.00	7.00	0.011
15268-2RS	15.00	26.00	8.00	0.011
16277-2RS	16.00	27.00	7.00	0.033
16287-2RS	16.00	28.00	7.00	0.034
163110-2RS	16.00	31.00	10.00	0.031
3803-2RS	17.00	26.00	10.00	
17286-2RS	17.00	28.00	6.00	
17287-2RS	17.00	28.00	7.00	0.014
3903-2RS	17.00	30.00	10.00	0.03
17328-2RS	17.00	32.00	8.00	0.02
18287-2RS	18.00	28.00	7.00	
18307-2RS	18.00	30.00	7.00	0.151
18379-2RS	18.00	37.00	9.00	
19307-2RS	19.00	30.00	7.00	
1905317-2RS	19.05	31.00	7.00	
3804-2RS	20.00	32.00	10.00	
20359-2RS	20.00	35.00	9.00	
20369-2RS	20.00	36.00	9.00	
23327-2RS	23.00	32.00	7.00	
24377-2RS	24.00	37.00	7.00	0.21
24378-2RS	24.00	37.00	8.00	0.019
28377-2RS	28.00	37.00	7.00	0.022
F3041H10	30.00	41.00	10.00	
F3041H12	30.00	41.00	12.00	
B542	33.20	44.50	7.120	
B543	39.70	50.80	7.044	

Keramiklager / Full Ceramic

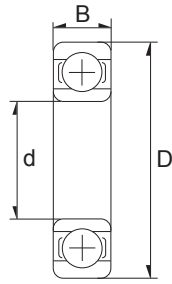

7

Ref Type	Dimension (mm)			Weight Kg
	d	D	B	
603-2PTFE-CE-FC-ZRO2-ZEN	3	9	3	0.001
603-CE-Si3N4-PTFE-ZEN	3	9	3	0.001
603-CE-ZRO2-PTFE-ZEN	3	9	3	0.001
604-2PTFE-CE-FC-ZRO2-ZEN	4	12	4	0.002
604-CE-Si3N4-PTFE-ZEN	4	12	4	0.002
604-CE-ZRO2-PTFE-ZEN	4	12	4	0.002
624-2PTFE-CE-FC-ZRO2-ZEN	4	13	5	0.003
624-CE-Si3N4-PTFE-ZEN	4	13	5	0.003
624-CE-ZRO2-PTFE-ZEN	4	13	5	0.003
605-2PTFE-CE-FC-ZRO2-ZEN	5	14	5	0.004
605-CE-Si3N4-PTFE-ZEN	5	14	5	0.004
605-CE-ZRO2-PTFE-ZEN	5	14	5	0.004
625-2PTFE-CE-FC-ZRO2-ZEN	5	16	5	0.004
625-CE-Si3N4-PTFE-ZEN	5	16	5	0.004
625-CE-ZRO2-PTFE-ZEN	5	16	5	0.004
606-2PTFE-CE-FC-ZRO2-ZEN	6	17	6	0.006
606-CE-Si3N4-PTFE-ZEN	6	17	6	0.006
606-CE-ZRO2-PTFE-ZEN	6	17	6	0.006
626-2PTFE-CE-FC-ZRO2-ZEN	6	19	6	0.009
626-CE-Si3N4-PTFE-ZEN	6	19	6	0.009
626-CE-ZRO2-PTFE-ZEN	6	19	6	0.009
607-2PTFE-CE-FC-ZRO2-ZEN	7	19	6	0.008
607-CE-Si3N4-PTFE-ZEN	7	19	6	0.008
607-CE-ZRO2-PTFE-ZEN	7	19	6	0.008
627-2PTFE-CE-FC-ZRO2-ZEN	7	22	7	0.013
627-CE-Si3N4-PTFE-ZEN	7	22	7	0.013
627-CE-ZRO2-PTFE-ZEN	7	22	7	0.013
608-2PTFE-CE-FC-ZRO2-ZEN	8	22	8	0.008
608-CE-OD26-ZRO2-PTFE-ZEN	8	26	8	0.012
608-CE-Si3N4-PTFE-ZEN	8	22	8	0.012
608-CE-ZRO2-PTFE-ZEN	8	22	8	0.012
628-2PTFE-CE-FC-ZRO2-ZEN	8	24	8	0.018
628-CE-Si3N4-PTFE-ZEN	8	24	8	0.018

Keramiklager / Full Ceramic

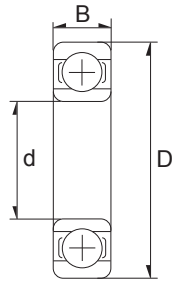

8

Ref Type	Dimension (mm)			Weight Kg
	d	D	B	
628-CE-ZRO2-PTFE-ZEN	8	24	8	0.018
609-2PTFE-CE-FC-ZRO2-ZEN	9	24	7	0.014
609-CE-Si3N4-PTFE-ZEN	9	24	7	0.014
609-CE-ZRO2-PTFE-ZEN	9	24	7	0.014
6000-2PTFE-CE-FC-ZRO2-ZEN	10	26	8	0.018
6000-CE-Si3N4-PTFE-ZEN	10	26	8	0.018
6000-CE-ZRO2-PTFE-ZEN	10	26	8	0.018
61800-2PTFE-CE-FC-ZRO2-ZEN	10	19	5	0.005
61800-CE-Si3N4-PTFE-ZEN	10	19	5	0.007
61800-CE-ZRO2-PTFE-ZEN	10	19	5	0.007
61900-2PTFE-CE-FC-ZRO2-ZEN	10	22	6	0.01
61900-CE-Si3N4-PTFE-ZEN	10	22	6	0.01
61900-CE-ZRO2-PTFE-ZEN	10	22	6	0.01
6200-2PTFE-CE-FC-ZRO2-ZEN	10	30	9	0.032
6200-CE-Si3N4-PTFE-ZEN	10	30	9	0.032
6200-CE-ZRO2-PTFE-ZEN	10	30	9	0.032
6001-2PTFE-CE-FC-ZRO2-ZEN	12	28	8	0.022
6001-CE-Si3N4-PTFE-ZEN	12	28	8	0.022
6001-CE-ZRO2-PTFE-ZEN	12	28	8	0.022
61801-2PTFE-CE-FC-ZRO2-ZEN	12	21	5	0.006
61801-CE-Si3N4-PTFE-ZEN	12	21	5	0.006
61801-CE-ZRO2-PTFE-ZEN	12	21	5	0.006
61901-2PTFE-CE-FC-ZRO2-ZEN	12	24	6	0.012
61901-CE-Si3N4-PTFE-ZEN	12	24	6	0.012
61901-CE-ZRO2-PTFE-ZEN	12	24	6	0.012
6201-2PTFE-CE-FC-ZRO2-ZEN	12	32	10	0.034
6201-CE-Si3N4-PTFE-ZEN	12	32	10	0.034
6201-CE-ZRO2-PTFE-ZEN	12	32	10	0.034
6002-2PTFE-CE-FC-ZRO2-ZEN	15	32	9	0.031
6002-CE-Si3N4-PTFE-ZEN	15	32	9	0.031
6002-CE-ZRO2-PTFE-ZEN	15	32	9	0.031
61802-2PTFE-CE-FC-ZRO2-ZEN	15	24	5	0.007
61802-CE-Si3N4-PTFE-ZEN	15	24	5	0.007

Keramiklager / Full Ceramic

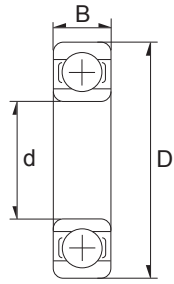

9

Ref Type	Dimension (mm)			Weight Kg
	d	D	B	
61802-CE-ZRO2-PTFE-ZEN	15	24	5	0.007
61902-2PTFE-CE-FC-ZRO2-ZEN	15	28	7	0.019
61902-CE-Si3N4-PTFE-ZEN	15	28	7	0.019
61902-CE-ZR02-PTFE-ZEN	15	28	7	0.019
6202-2PTFE-CE-FC-ZRO2-ZEN	15	35	11	0.048
6202-CE-Si3N4-PTFE-ZEN	15	35	11	0.048
6202-CE-ZRO2-PTFE-ZEN	15	35	11	0.048
6003-2PTFE-CE-FC-ZRO2-ZEN	17	35	10	0.041
6003-CE-Si3N4-PTFE-ZEN	17	35	10	0.041
6003-CE-ZRO2-PTFE-ZEN	17	35	10	0.041
61803-2PTFE-CE-FC-ZRO2-ZEN	17	26	5	0.008
61803-CE-Si3N4-PTFE-ZEN	17	26	5	0.008
61803-CE-ZRO2-PTFE-ZEN	17	26	5	0.008
61903-2PTFE-CE-FC-ZRO2-ZEN	17	30	7	0.021
61903-CE-Si3N4-PTFE-ZEN	17	30	7	0.021
61903-CE-ZRO2-PTFE-ZEN	17	30	7	0.021
6203-2PTFE-CE-FC-ZRO2-ZEN	17	40	12	0.068
6203-CE-Si3N4-PTFE-ZEN	17	40	12	0.068
6203-CE-ZRO2-PTFE-ZEN	17	40	12	0.068
6004-2PTFE-CE-FC-ZRO2-ZEN	20	42	12	0.068
6004-CE-Si3N4-PTFE-ZEN	20	42	12	0.068
6004-CE-ZRO2-PTFE-ZEN	20	42	12	0.068
61804-2PTFE-CE-FC-ZRO2-ZEN	20	32	7	0.018
61804-CE-Si3N4-PTFE-ZEN	20	32	7	0.018
61804-CE-ZRO2-PTFE-ZEN	20	32	7	0.018
61904-2PTFE-CE-FC-ZRO2-ZEN	20	37	9	0.04
61904-CE-Si3N4-PTFE-ZEN	20	37	9	0.04
61904-CE-ZRO2-PTFE-ZEN	20	37	9	0.04
6204-2PTFE-CE-FC-ZRO2-ZEN	20	47	14	0.11
6204-CE-Si3N4-PTFE-ZEN	20	47	14	0.11
6204-CE-ZRO2-PTFE-ZEN	20	47	14	0.11
61805-2PTFE-CE-FC-ZRO2-ZEN	25	37	7	0.024
61805-CE-Si3N4-PTFE-ZEN	25	37	7	0.024

Keramiklager / Full Ceramic

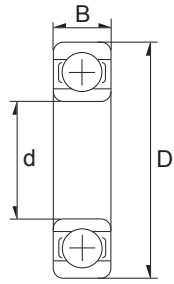

10

Ref Type	Dimension (mm)			Weight Kg
	d	D	B	
61805-CE-ZRO2-PTFE-ZEN	25	37	7	0.024
61905-2PTFE-CE-FC-ZRO2-ZEN	25	42	9	0.047
61905-CE-Si3N4-PTFE-ZEN	25	42	9	0.047
61905-CE-ZRO2-PTFE-ZEN	25	42	9	0.047
61806-2PTFE-CE-FC-ZRO2-ZEN	30	42	7	0.027
61806-CE-Si3N4-PTFE-ZEN	30	42	7	0.027
61806-CE-ZRO2-PTFE-ZEN	30	42	7	0.027
61906-2PTFE-CE-FC-ZRO2-ZEN	30	47	9	0.053
61906-CE-Si3N4-PTFE-ZEN	30	47	9	0.053
61906-CE-ZRO2-PTFE-ZEN	30	47	9	0.053
61808-2PTFE-CE-FC-ZRO2-ZEN	40	52	7	0.035
61808-CE-Si3N4-PTFE-ZEN	40	52	7	0.035
61808-CE-Si3N4-PTFE-ZEN	40	52	7	0.035
61908-2PTFE-CE-FC-ZRO2-ZEN	40	37	9	0.131
61908-CE-Si3N4-PTFE-ZEN	40	37	9	0.131
61908-CE-ZRO2-PTFE-ZEN	40	37	9	0.131

Zen are proud sponsors of Paralympic bronze medalist Amador Granados

Amador Granados won the bronze medal in track cycling at the Rio 2016 Paralympic games.

Amador approached the Zen Group to help him find the perfect wheel bearing with minimal friction. Together we tested and developed a set of modified full ceramic bearings (6001-CE-Si3N4-PTFE-ZEN, and 6901-CE-Si3N4-PTFE-ZEN) that helped Amador go on and win a bronze medal in the Mixed Team Sprint Class C1-5.

Amador Granados secured another bronze in the team sprint UCI Para-cycling Track World Championships in 2018.



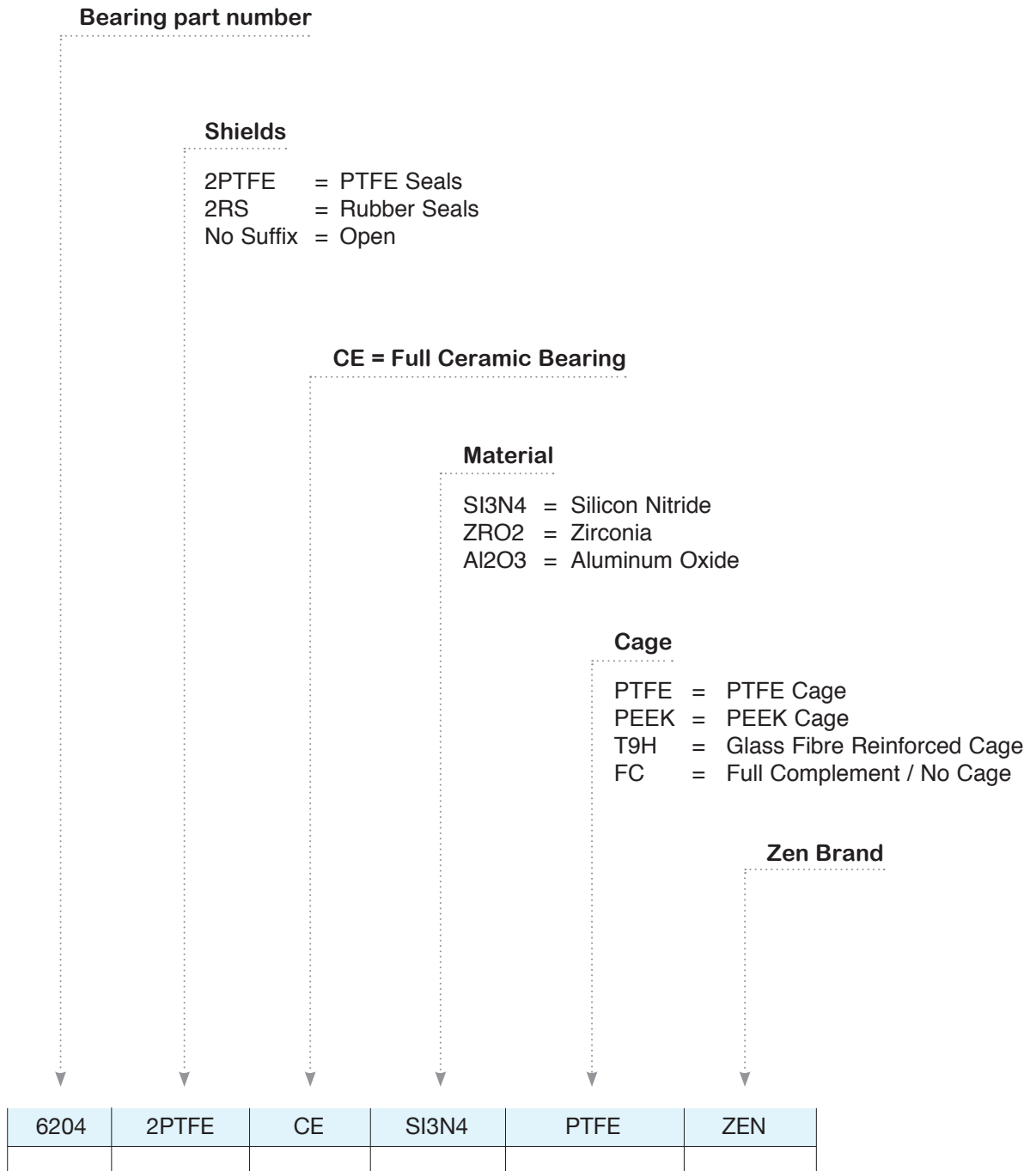

Hybridkugellager / Hybrid

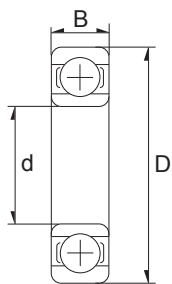

13

Ref Type	Dimension (mm)			Weight Kg
	d	D	B	
S623-2Z-CB-ZEN	3	10	4	0.001
S623-2RS-ZEN	3	10	4	0.002
S624-2RS-CB-ZEN	4	13	5	0.003
S624-2Z-CB-ZEN	4	13	5	0.003
S625-2Z-CB-ZEN	5	16	5	0.005
S625-2RS-CB-ZEN	5	16	5	0.005
S626-2RS-CB-ZEN	6	19	6	0.008
S626-2Z-CB-ZEN	6	19	6	0.008
S606-2RS-CB-ZEN	6	17	6	0.006
S606-2Z-CB-ZEN	6	17	6	0.006
S627-2Z-CB-ZEN	7	22	7	0.013
S627-2RS-CB-ZEN	7	22	7	0.013
S608-2RSCB-ZEN	8	22	7	0.012
S608-2Z-CB-ZEN	8	22	7	0.012
S609-2RS-CB-ZEN	9	24	7	0.016
S609-2Z-CB-ZEN	9	24	7	0.016
S629-2RS-CB-ZEN	9	26	8	0.021
S629-2Z-CB-ZEN	9	26	8	0.021
S6000-2RS-CB-ZEN	10	26	8	0.018
S6000-2Z-CB-ZEN	10	26	8	0.018
S61800-2RS-CB-ZEN	10	19	5	0.005
S61800-2Z-CB-ZEN	10	19	5	0.005
S61900-2RS-CB-ZEN	10	22	6	0.01
S61900-2Z-CB-ZEN	10	22	6	0.01
S6200-2RS-CB--ZEN	10	30	9	0.031
S6200-2Z-CB-ZEN	10	30	9	0.031
S6001-2RS-CB-ZEN	12	28	8	0.022
S6001-2Z-CB-ZEN	12	28	8	0.022
S61801-2RS-CB-ZEN	12	21	5	0.006
S61801-2Z-CB-ZEN	12	21	5	0.006
S61901-2RS-CB-ZEN	12	24	6	0.012
S61901-2Z-CB-ZEN	12	24	6	0.012
S6201-2RS-CB-ZEN	12	32	10	0.034

Hybridkugellager / Hybrid

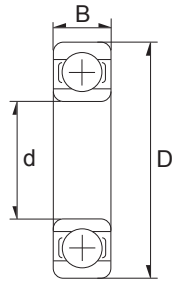

14

Ref Type	Dimension (mm)			Weight Kg
	d	D	B	
S6201-2Z-CB-ZEN	12	32	10	0.034
S61802-2RS-CB-ZEN	15	24	5	0.007
S61802-2Z-CB-ZEN	15	24	5	0.007
S61902-2RS-CB-ZEN	15	28	7	0.019
S61902-2Z-CB-ZEN	15	28	7	0.019
S6002-2RS-CB-ZEN	15	32	9	0.031
S6002-2Z-CB-ZEN	15	32	9	0.031
S6202-2RS-CB-ZEN	15	32	11	0.043
S6202-2Z-CB-ZEN	15	32	11	0.043
S6003-2RS-CB-ZEN	17	35	10	0.041
S6003-2Z-CB-ZEN	17	35	10	0.041
S61803-2RS-CB-ZEN	17	26	5	0.008
S61803-2Z-CB-ZEN	17	26	5	0.008
S61903-2RS-CB-ZEN	17	30	7	0.02
S61903-2Z-CB-ZEN	17	30	7	0.02
S6203-2RS-CB-ZEN	17	40	12	0.062
S6203-2Z-CB-ZEN	17	40	12	0.062
S6004-2RS-CB-ZEN	20	42	12	0.068
S6004-2Z-CB-ZEN	20	42	12	0.068
S61804-2RS-CB-ZEN	20	32	7	0.018
S61804-2Z-CB-ZEN	20	32	7	0.018
S61904-2RS-CB-ZEN	20	37	9	0.04
S61904-2Z-CB-ZEN	20	37	9	0.04
S6204-2RS-CB-ZEN	20	47	14	0.1
S6204-2Z-CB-ZEN	20	47	14	0.1
S61805-2RS-CB-ZEN	25	37	7	0.024
S61805-2Z-CB-ZEN	25	37	7	0.024
S61905-2RS-CB-ZEN	25	42	9	0.047
S61905-2Z-CB-ZEN	25	42	9	0.047
S61806-2RS-CB-ZEN	30	42	7	0.027
S61806-2Z-CB-ZEN	30	42	7	0.027
S61906-2RS-CB-ZEN	30	47	9	0.053
S61906-2Z-CB-ZEN	30	47	9	0.053

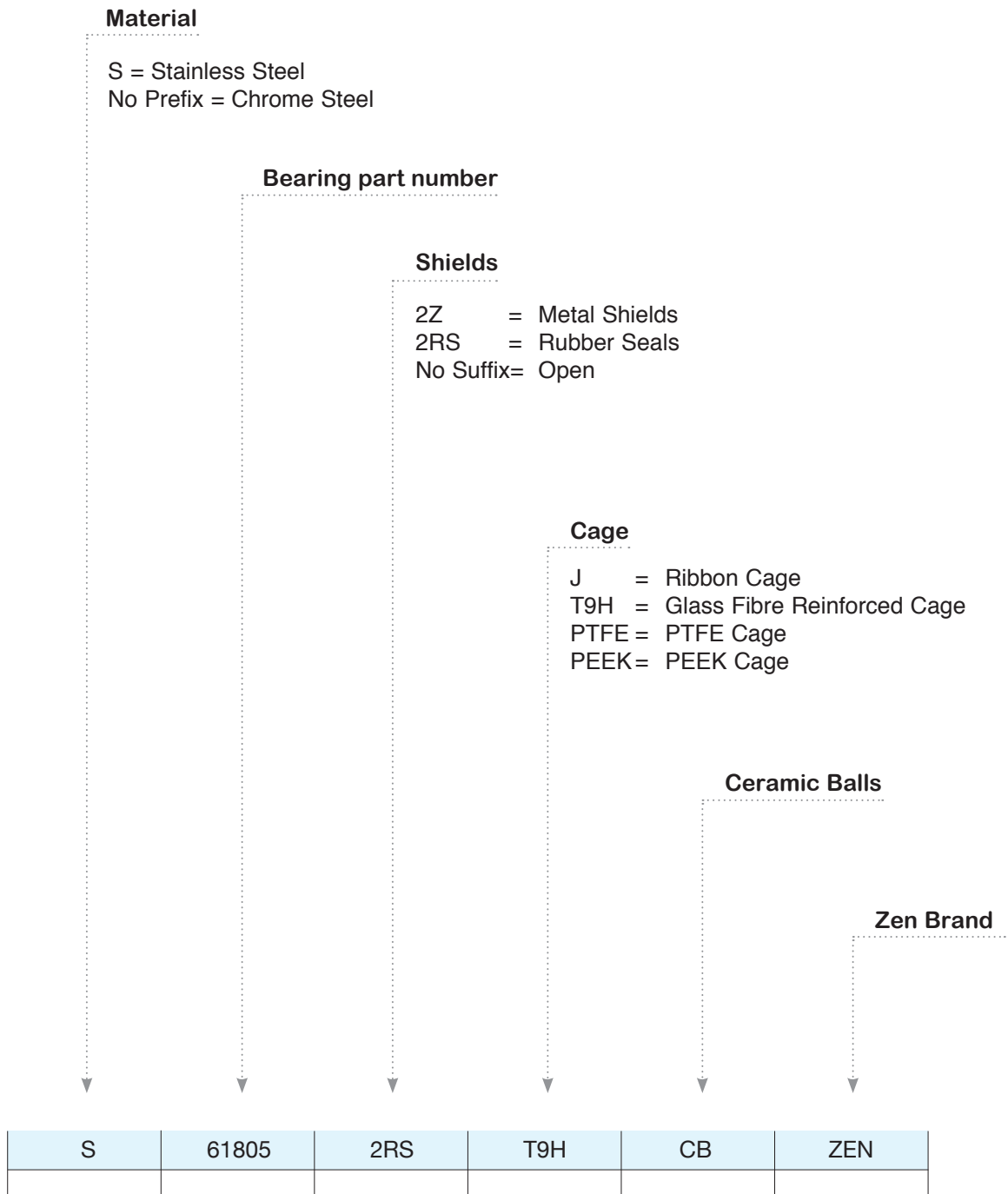



www.zen.biz

Alle Rechte vorbehalten, kein Teil des Katalogs darf in irgendeiner Form (Druck, Fotokopie, Mikrofilm oder in einem anderen Verfahren) ohne Genehmigung reproduziert oder unter Verwendung elektronischer Systeme verarbeitet, vervielfältigt oder verbreitet werden.

Copyright reserved. No part of the catalogue is to be copied, extracted or modified without explicit permission from the copyright holder.

v.10 / 18

ZEN™

Bearings for your future



1976 - 2019

www.juncor.pt

PORTAL B2B:

- Compras online
- Orçamento na hora
- Esclarecimento de dúvidas: Preços e Stocks
- Encomendas
- Licitação
- Descontos
- Eficiência e Segurança

Redes sociais

Facebook: www.facebook.com/juncor

Twitter: www.twitter.com/juncor_sa

LinkedIn: www.linkedin.com/company/juncor-sa

Instagram: www.instagram.com/juncor_sa

Pinterest: www.pinterest.pt/juncorsa

Canal Youtube: www.youtube.com/juncoraccess

“Adicionamos movimento ao seu negócio!”